

Floor Plan

Room: room1

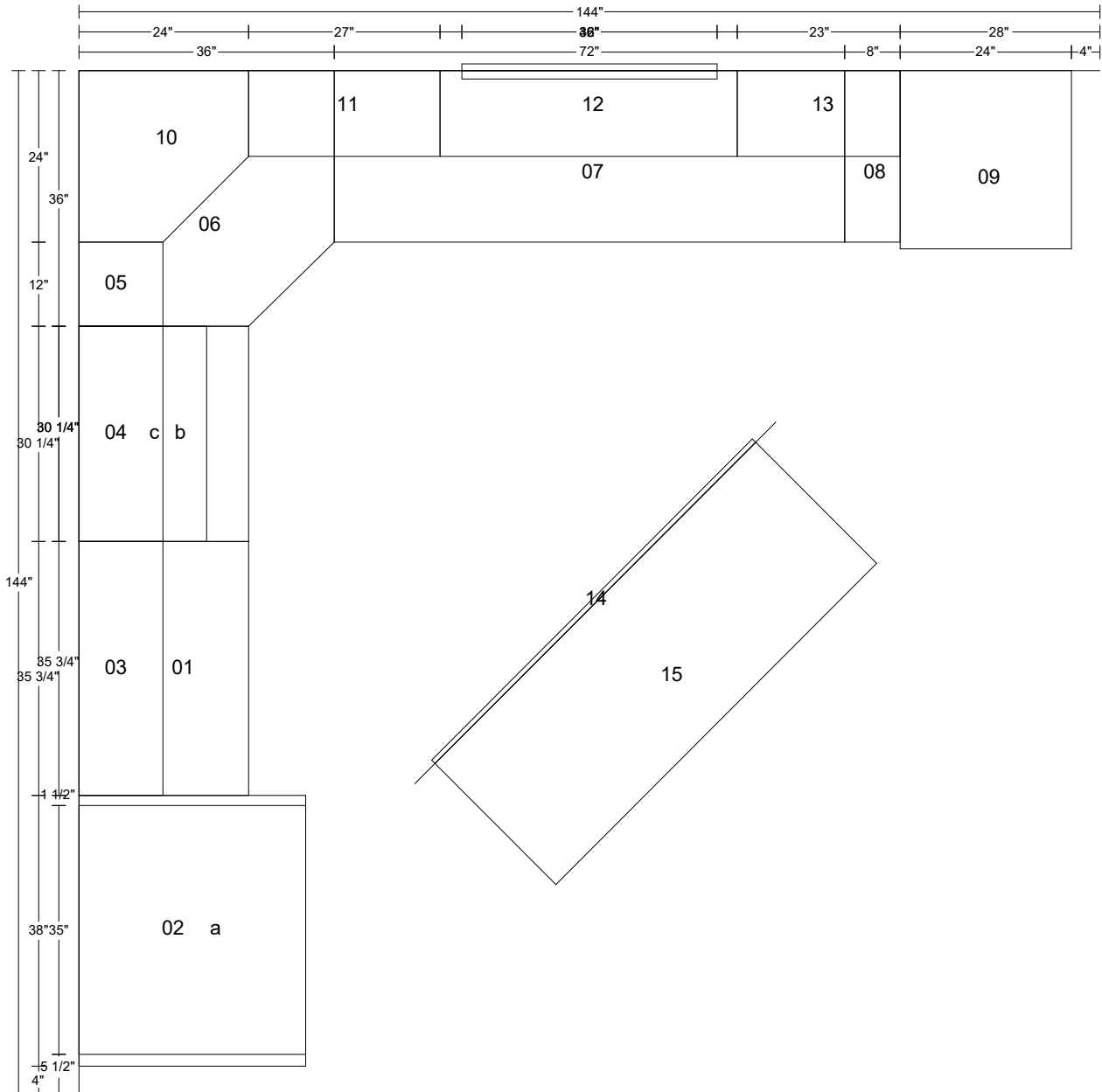

- 15 = wall3 cab 15 [Sink Base] 64" X 34 1/2" X 24"
- 14 = wall3 cab 14 [Wainscot] 64" X 34 1/2" X 3/4"
- 13 = wall2 cab 13 [Upper] 23" X 42" X 12"
- 12 = wall2 cab 12 [C:\Users\eddy\] 42" X 5" X 12"
- 11 = wall2 cab 11 [Upper] 27" X 42" X 12"
- 10 = wall2 cab 10 [Angle Corner Upper] 24" X 42" X 24"
- 09 = wall2 cab 09 [Full Ht Pantry] 24" X 96" X 25"
- 08 = wall2 cab 08 [Base] 8" X 34 1/2" X 24"
- 07 = wall2 cab 07 [Sink Base] 72" X 34 1/2" X 24"
- 06 = wall2 cab 06 [Angle Corner Base] 36" X 34 1/2" X 36"
- 05 = wall1 cab 05 [Upper] 12" X 42" X 12"
- 04 = wall1 cab 04 [Hood Cab] 30 1/4" X 30" X 12"

- 03 = wall1 cab 03 [Upper] 35 3/4" X 42" X 12"
- 02 = wall1 cab 02 [Refer Upper] 38" X 30" X 32"
- 01 = wall1 cab 01 [Base] 35 3/4" X 34 1/2" X 24"
- c = wall1 MW/Hood Combo 01 30 1/4" X 15" X 18"
- b = wall1 Slide in Range 01 30 1/4" X 35 1/2" X 24"
- a = wall1 Refrigerator 01 35" X 64" X 32"